

SAFEMASTER STS Safety switch- and key interlock system Mounting Plate CS

Translation of the
german original



STS-System Benefits

- EU-Test certificate according to the directive 2006/42/EG, annex IX
- For safety applications up to PLe/Category 4 according to EN/ISO 13849-1
- Modular and expandable system
- Rugged stainless steel design
- Wireless mechanical safeguarding
- Combines the benefits of safety switch, locking module and key transfer in a single system
- Easy installation through comprehensive accessories
- Protection against lock-in
- Coding level low, medium, high according to DIN EN ISO 14119:2014-03

Features

- For mounting of actuator CS
- Easier mounting
- Height adjustment when using functional units with the mounting plate

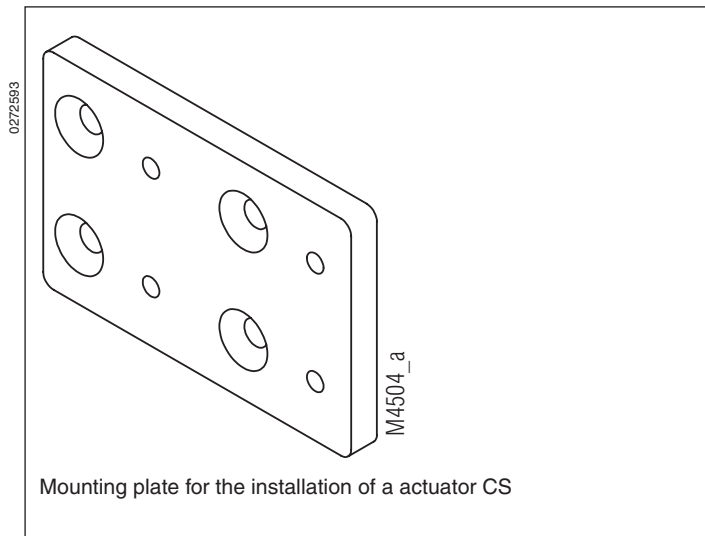

Mounting plate for the installation of an actuator CS

Installation Example

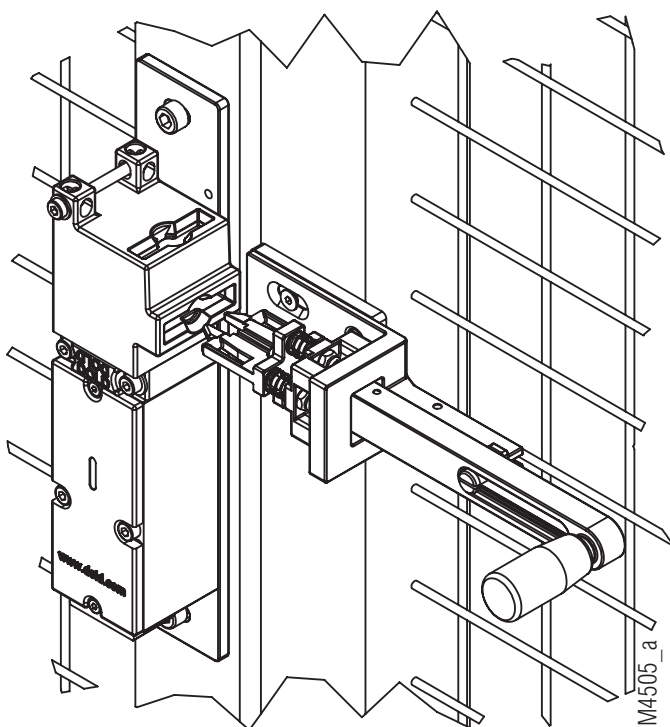

STS-SXA on mounting plate and STS-CS actuator on mounting plate CS at a hinged door of a protective fence

Application

The mounting plate CS facilitates the easy fitting of a SAFEMASTER STS-CS actuator to machines and plants.

It is also used to compensate height differences with STS units fastened with mounting plates.

Design and Function of the Mounting Plate

The mounting plate CS is made of acid-resistant stainless steel 1.4404 (V4A / AISI 316L). The countersunk holes included allow many different mounting options of the CS actuator.

The mounting plate CS is suitable for fitting to fences and system sections. The plate can thereby be fastened with bolts or by welding.

Important Note

EN ISO 13849 stipulates measures for preventing faults of common causes (CCF).

This includes the detachment of the mounting plate. We therefore recommend fastening the mounting plate with preinstalled CS actuator on the plant or protective fence with several welds or to secure it in some other way against loosening (see Mounting Examples).

Technical Data

Material: Stainless steel V4A / AISI 316
 Application: Mounting plate CS for the installation of a SAFEMASTER STS actuator CS

Dimensional Drawing [mm]

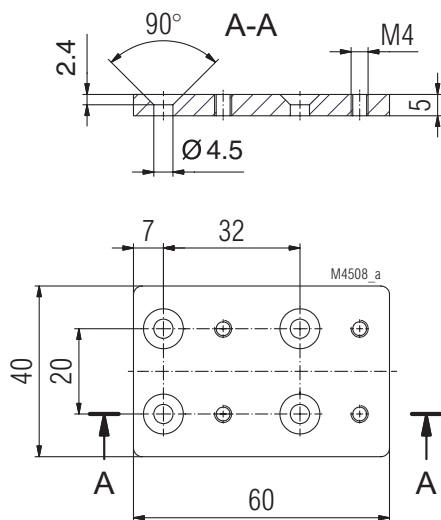

Ordering Designation

Mounting plate CS
 Article number: 0065191

Included in scope of delivery:
 One mounting plate CS and screws
 M4 x 8 mm (3 pcs.), M4 x 16 mm (4 pcs.), M4 x 8 mm with pin (1 pc.)

The actuator is not supplied preinstalled on the mounting plate.

Accessories

All versions of the CS actuator can be installed on the mounting plate CS. For more information, refer to the data sheet STS-CS actuator.

Mounting Example

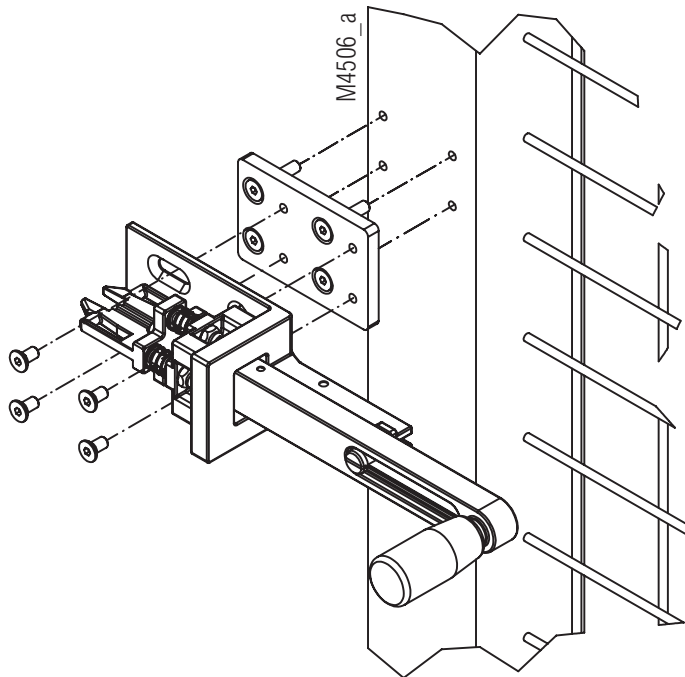

Actuator CS and mounting plate CS bolted in place

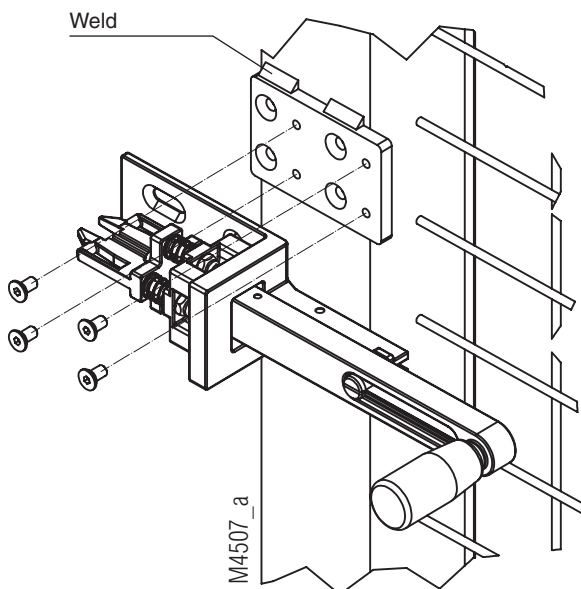

Actuator CS and mounting plate CS welded in place